

## Home Setup

Trond Reinholdtsen, Oslo

*Note: Tutorial Diversions reminds you to document your own Home Setup before building up any other!*

Trond Reinholdtsen's Home Setup is constituted by level Left and Right speakers oriented along a single wall. If your own stereo system is made up of a single unit with integrated speakers and player, simply ignore the calculations for Left and Right speaker and set up your system according to the *Middle-point* and the Height calculations below.

Trond Reinholdtsen's Home Setup is oriented along an East wall. To reconstruct Trond Reinholdtsen's Home Setup in your own space, you will need to plug the dimensions of your own East wall into the following equations.

*Note: in Trond Reinholdtsen's Home Setup Left and Right Speakers are reversed (Right is on the Left, Left on the Right).*

$$\begin{array}{l} \text{_____} \\ \text{Total Height of your East wall} \end{array} \times \frac{1/63}{\text{Ratio of Trond Reinholdtsen's Speakers to the Total Height of his East Wall}} = \text{_____} \\ \text{Distance from the Ground of your East Wall}$$
$$\begin{array}{l} \text{_____} \\ \text{Total Width of your East wall} \end{array} \times \frac{11/41}{\text{Ratio of T.R.'s Left Speaker from the Right Side* of his East Wall to the Total Width of his East Wall}} = \text{_____} \\ \text{Distance from your Left Speaker to the Right Side of your East Wall}$$
$$\begin{array}{l} \text{_____} \\ \text{Total Width of your East wall} \end{array} \times \frac{2/41}{\text{Ratio of T.R.'s Right Speaker from the Right Side of his East Wall to the Total Width of his East Wall}} = \text{_____} \\ \text{Distance from your Right Speaker to the Right Side of your East Wall}$$
$$\begin{array}{l} \text{_____} \\ \text{Total Width of your East wall} \end{array} \times \frac{13/82}{\text{Ratio of the Middlepoint of T.R.'s Setup from the Right Side his East Wall to the Total Width of his East Wall}} = \text{_____} \\ \text{Distance from the middle point of your Right Side of your East Wall}$$

\* All references to Right or Left in relation to a given wall are references facing that wall

Arnenordheimsmedlemsskapssøknadstarse

1. Nordheimlatter 0:31

2. Nordheimlatter 0:02

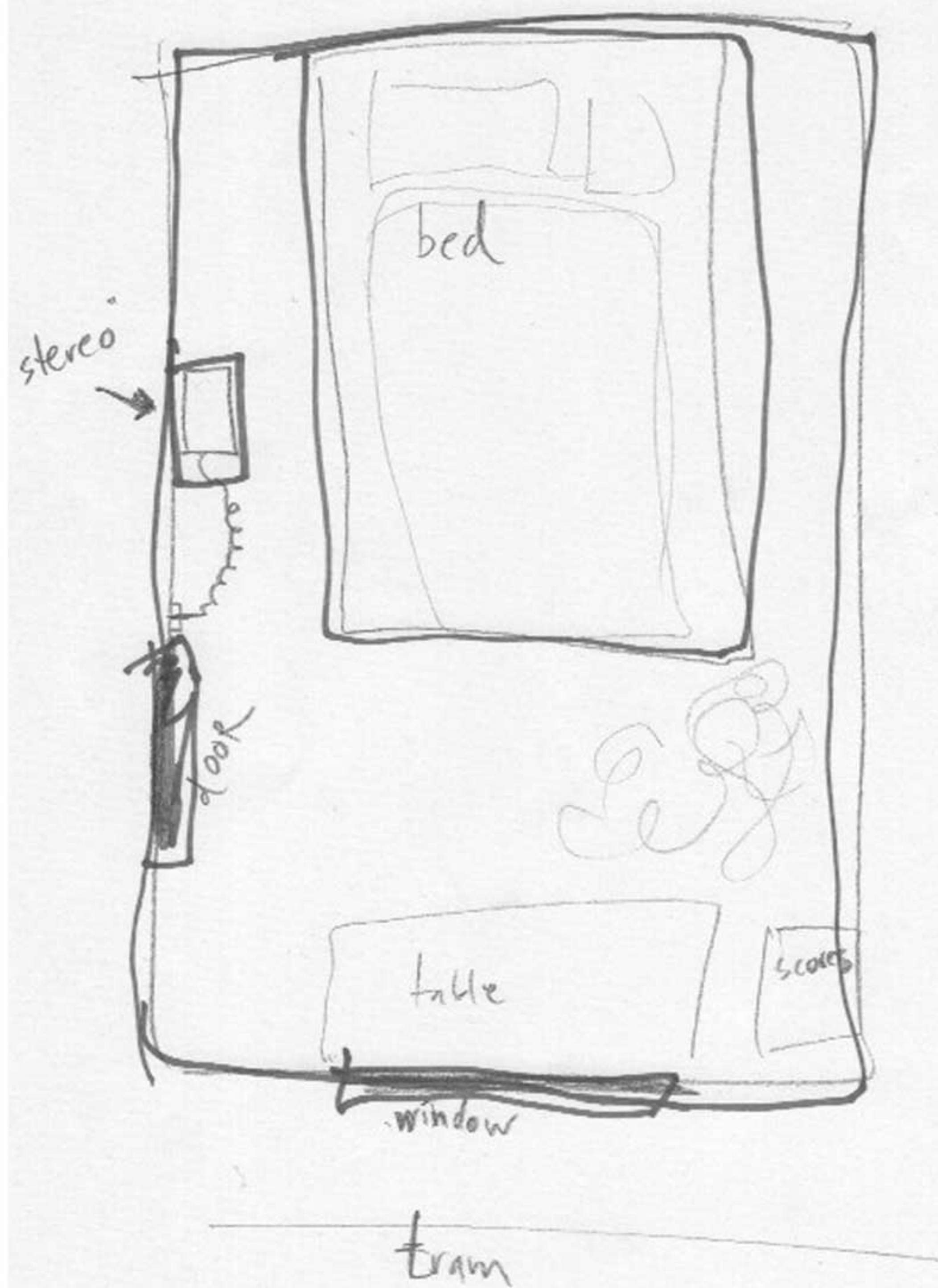

My very small stereo (a little cd-player with radio costing around 30 euros) is positioned in my bedroom. It can almost be seen on the picture I attach ("my listening space").

My window on the drawing is towards the north and the stereo towards east. ("my stereo picture")

My stereo is positioned on the floor. The loudspeakers 5 centimeters above floor level. Speaker L is at 1.10 meter left of A (A= south), Speaker R is at 3.90 meters right to B (north). A - B = 4.10 meters

The wall is 3.15 meters high.

Outside the window of my listening room is a quite noisy road which can be heard on the recording.

The recording is made with a Zoom H4.

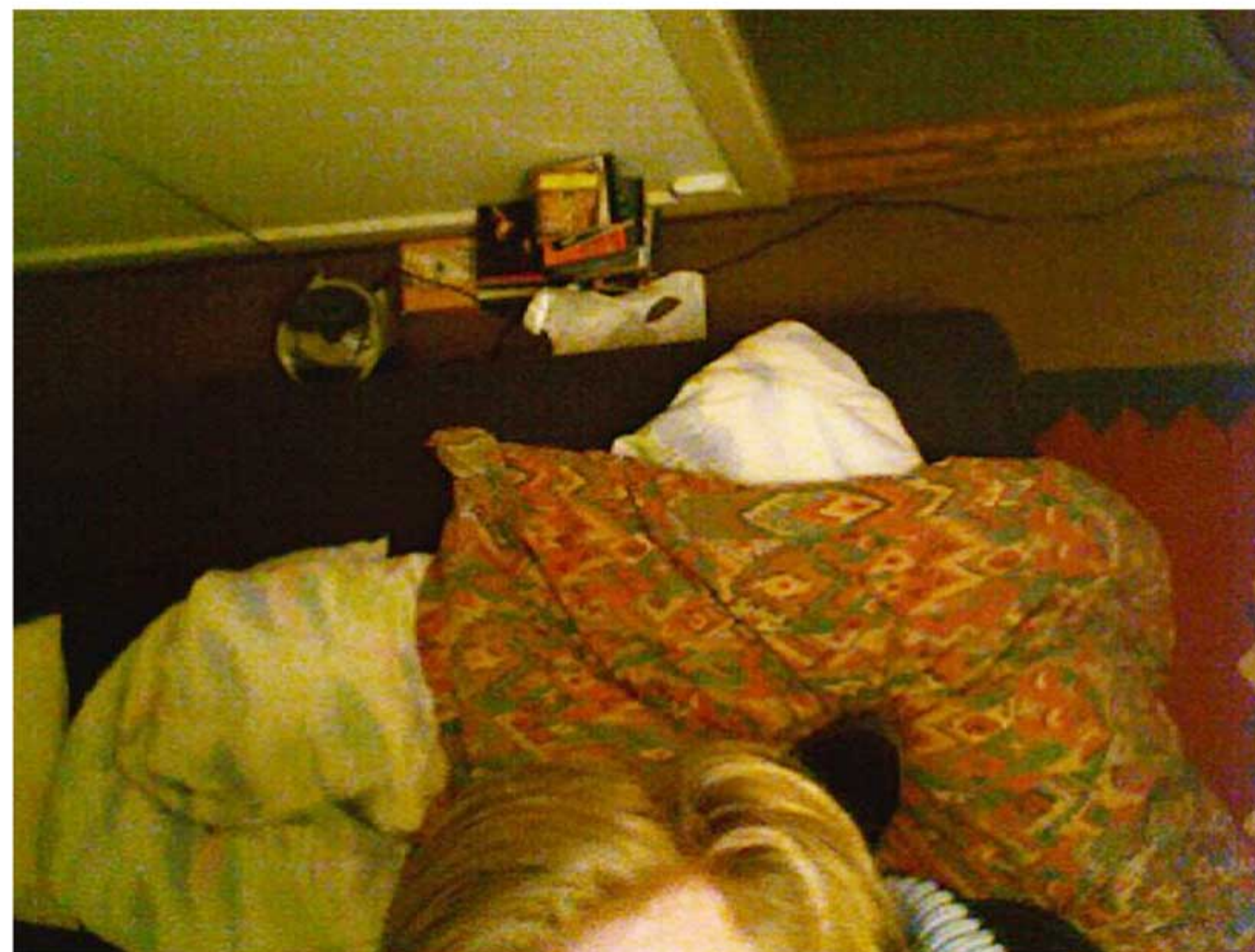



**2nd Generation/Berlin - *ohrenhoch***